

CONA[®] B

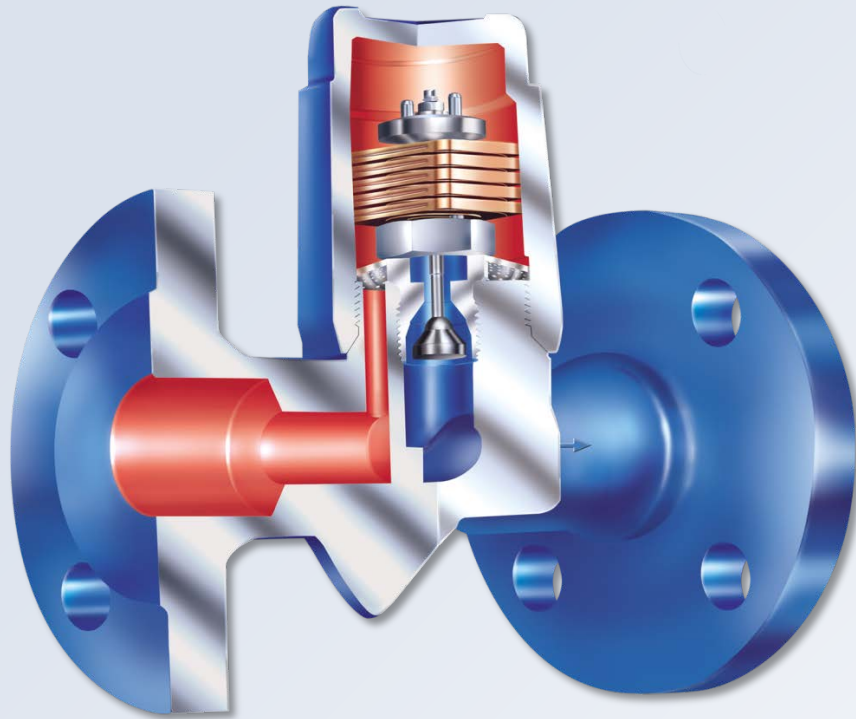

Bimetallic steam trap

- ▶ DN15 – DN50
- ▶ PN16 – PN630 / ANSI150 – ANSI2500
- ▶ Temperature up to 650°C
- ▶ For discharging of slight to highly sub-cooled condensate
- ▶ Automatic air-venting during start up and operation of the plant
- ▶ Multiple connection types
- ▶ Body material, for example
 - EN-JL 1040
 - 1.0460
 - 16Mo3
 - 1.4541
 - 10CrMo9-10 (1.7380)
- ▶ Robust and resistant to water-hammer
- ▶ Integrated non return protection
- ▶ Design with internal strainer – Fig. 600
- ▶ Construction with outside strainer – Fig. 601 (y)
- ▶ Optional
 - blow down valve

CONA[®] B

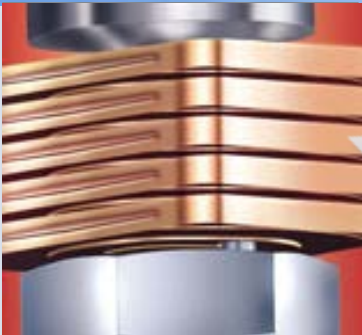

Profiling of bi-metallic plates for long life (dirt resistance), giving optimum reaction speed to temperature change

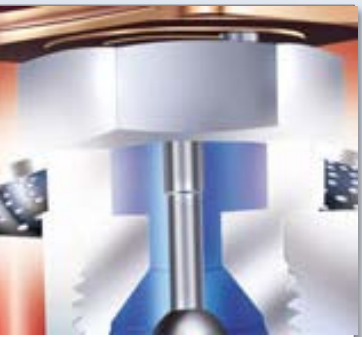

Protection for long life against contamination (integral strainer screen).
Additional external screen also available

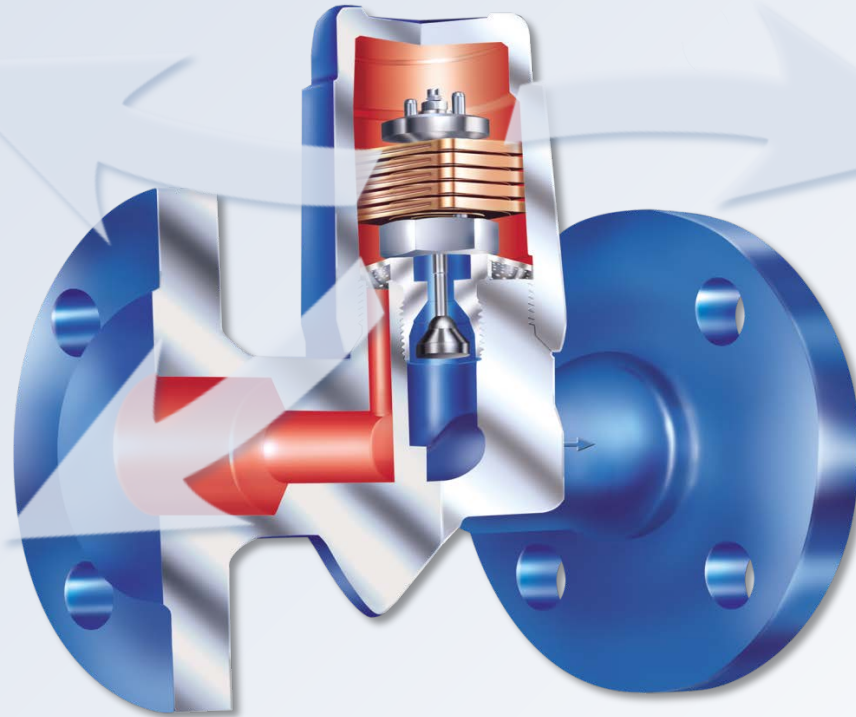

Self aligning stem and combination check valve gives high-performance precision

CONA[®] B

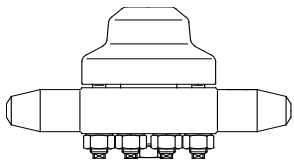

▶ Bimetallic steam trap with inside strainer

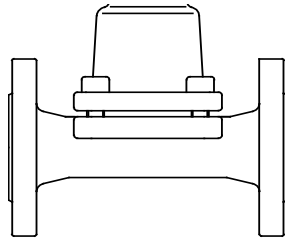

▶ Bimetallic steam trap with inside strainer and flanges

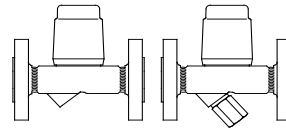

▶ Bimetallic steam trap with outside strainer

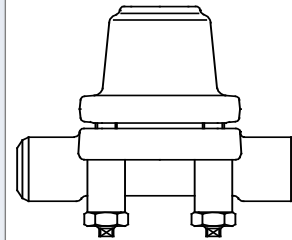

▶ Bimetallic steam trap with inside strainer and screwed socket PN 63

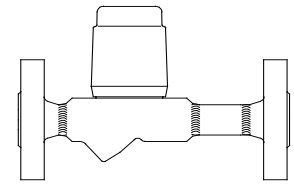

▶ Bimetallic steam trap with inside strainer and screw cap with plug

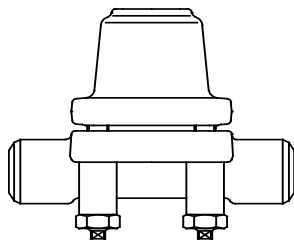

▶ Bimetallic steam trap with inside strainer PN 160