

List of materials

Table D.1.1

Item	Part	APPLICATION			
		up to 400 °C	up to 450 °C	up to 550 °C	
1	BODY	1.0619 (3E0)	1.7357 (5E0)	1.7357 (5E0)	1.4552 (12E0) 1.4408 (14E0)
2	BONNET	1.0619 (3E0)	1.7357 (5E0)	1.7357 (5E0)	1.4552 (12E0) 1.4408 (14E0)
3	WEDGE	1.0619 (3E0)	1.7357 (5E0)	1.7357 (5E0)	1.4552 (12E0) 1.4408 (14E0)
4	TRIM	BODY SEATING SURFACES	min 13% Cr welded	min 17% Cr welded	STELLITE welded
5		WEDGE SEATING SURFACES	min 13% Cr welded	min 17% Cr welded	STELLITE welded
6		STEM	min 13% Cr		
7	STEM NUT	2.0940 (or 1.1191)			2.0940
8	STUD BOLTS	1.7225		1.7709	1.4301
9	NUTS	1.1191		1.7709	1.4301
10	BONNET GASKET	reinforced pure graphite			
11	STEM PACKING	pure graphite			
12	HANDWHEEL	cast steel			

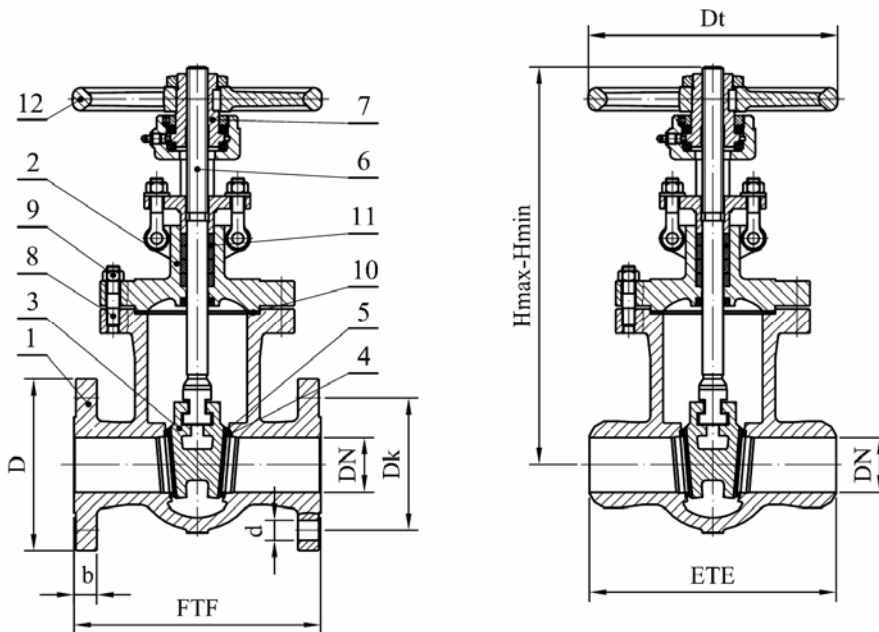

Standards

Table D.1.2

GATE VALVE according to EN 1984	PN 16 and PN 25	PN 40	PN 63 and PN 100
Face-to-face dimensions according to	EN 558-1, Serie 15	EN 558-1, Serie 26	EN 558-1, Serie 26
Flanged ends according to	EN 1092-1, Type B1	EN 1092-1, Type B1	EN 1092-1, Type B2
End-to-end dimensions according to	EN 12982, Serie 15	EN 12982, Serie 26	
Welding ends according to	EN 12627		

Dimensions PN 100

Table D.1.7

DN	FTF mm	ETE mm	D mm	b mm	Dk mm	d mm	n	H max mm	H min mm	Dt mm	Weight FTF kg	Weight ETE kg
40	240	240	170	26	125	22	4	302	254	150	16	8,5
50	250	250	195	28	145	26	4	455	385	250	50	40
65	290	290	220	30	170	26	8	520	440	250	63	49
80	310	310	230	32	180	26	8	555	459	250	77	61
100	350	350	265	36	210	30	8	664	544	315	120	97
125	400	400	315	40	250	33	8	746	601	315	164	128
150	450	450	355	44	290	33	8	921	746	500	261	212
200	550	550	430	52	360	36	12	1090	865	500	434	352
250	650	650	505	60	430	39	12	1335	1060	630	689	563
300	750	750	585	68	500	42	16	1514	1184	630	1000	813