

List of materials

Table D.1.1

Item	Part	APPLICATION			
		up to 400 °C	up to 450 °C	up to 550 °C	
1	BODY	1.0619 (3E0)	1.7357 (5E0)	1.7357 (5E0)	1.4552 (12E0) 1.4408 (14E0)
2	BONNET	1.0619 (3E0)	1.7357 (5E0)	1.7357 (5E0)	1.4552 (12E0) 1.4408 (14E0)
3	WEDGE	1.0619 (3E0)	1.7357 (5E0)	1.7357 (5E0)	1.4552 (12E0) 1.4408 (14E0)
4	TRIM	BODY SEATING SURFACES	min 13% Cr welded	min 17% Cr welded	STELLITE welded
5		WEDGE SEATING SURFACES	min 13% Cr welded	min 17% Cr welded	STELLITE welded
6		STEM	min 13% Cr		
7	STEM NUT	2.0940 (or 1.1191)			2.0940
8	STUD BOLTS	1.7225		1.7709	1.4301
9	NUTS	1.1191		1.7709	1.4301
10	BONNET GASKET	reinforced pure graphite			
11	STEM PACKING	pure graphite			
12	HANDWHEEL	cast steel			

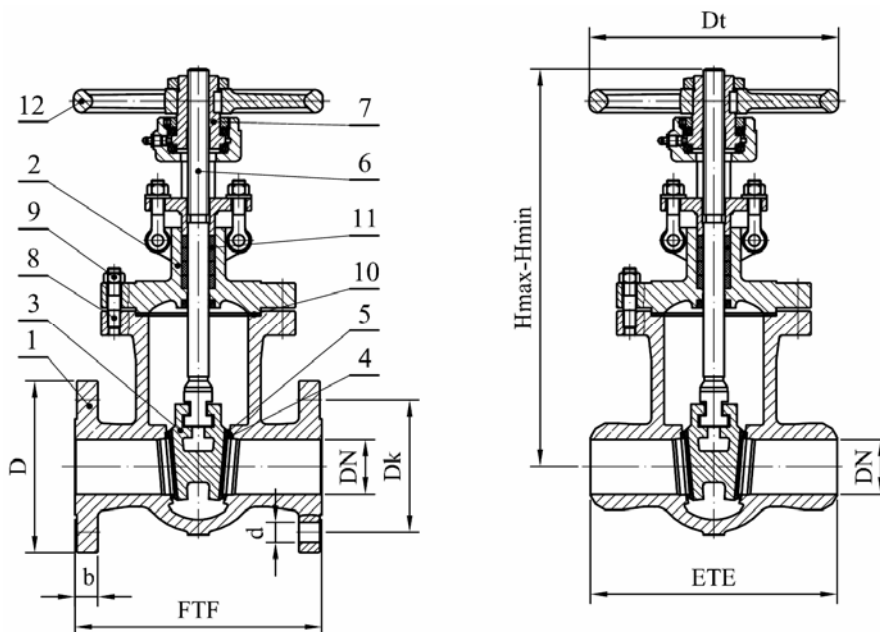

Standards

Table D.1.2

GATE VALVE according to EN 1984	PN 16 and PN 25	PN 40	PN 63 and PN 100
Face-to-face dimensions according to	EN 558-1, Serie 15	EN 558-1, Serie 26	EN 558-1, Serie 26
Flanged ends according to	EN 1092-1, Type B1	EN 1092-1, Type B1	EN 1092-1, Type B2
End-to-end dimensions according to	EN 12982, Serie 15	EN 12982, Serie 26	
Welding ends according to	EN 12627		

Dimensions PN 40

Table D.1.5

DN	FTF mm	ETE mm	D mm	b mm	Dk mm	d mm	n	H max mm	H min mm	Dt mm	Weight FTF kg	Weight ETE kg
40	240	240	150	18	110	18	4	302	254	150	14	8,5
50	250	250	165	20	125	18	4	455	385	250	34,2	32
65	290	290	185	22	145	18	8	520	440	250	48	49
80	310	310	200	24	160	18	8	555	459	250	60	52
100	350	350	235	24	190	22	8	664	544	250	72	61
125	400	400	270	26	220	26	8	746	601	315	118	103
150	450	450	300	28	250	26	8	921	746	400	167	146
200	550	550	375	34	320	30	12	1090	865	500	267	215
250	650	650	450	38	385	33	12	1335	1060	500	410	355
300	750	750	515	42	450	33	16	1514	1184	500	565	490