

## VK70 / VK71 – PŘERUŠOVAČ VAKUA ZÁVITOVÝ

### CHARACTERISTICS

The VK vacuum breaker is an accessory permitting air intake in the pipes when operating conditions turn to depression. The induced vacuum prevents the normal flow of the fluid and puts the installation safety at risk. The vacuum breaker is particularly recommended on steam pipework (to avoid the vacuum into the system at shutdown and prevent steam condensation) and on steam exchangers (the system is put under vacuum when there is a non stationary heat exchange). This device is available in brass and stainless steel version.

### AVAILABLE ITEMS

1/2" brass or 1/2" stainless steel inlet BSP threaded connections  
Air intake 1/8" BSP

### LIMITS OF USE

	VK70	VK71
Max. body pressure	PN 16 brass	PN 40 stainless steel
Max. allowable temperature	260 °C	300 °C



### PRESSURE / TEMPERATURE DIAGRAM

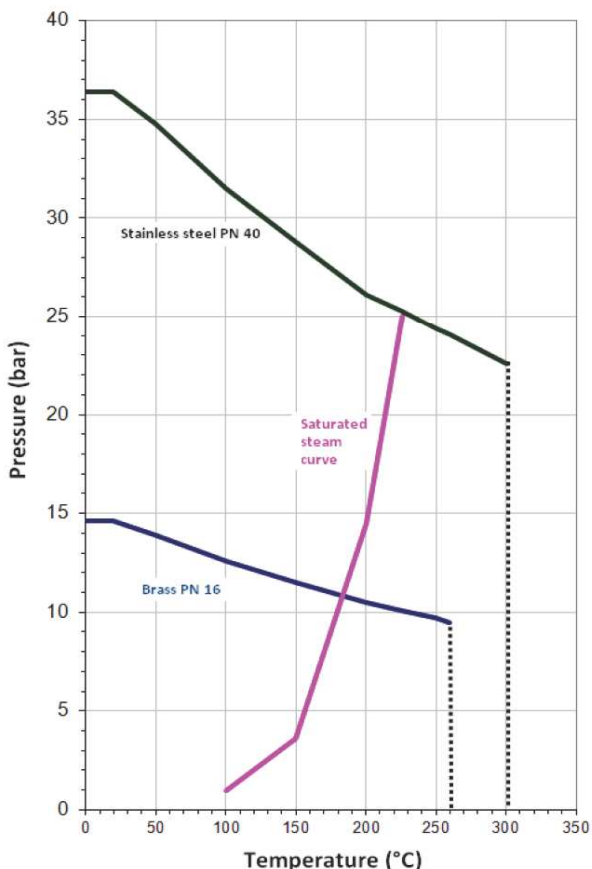

### CONSTRUCTION

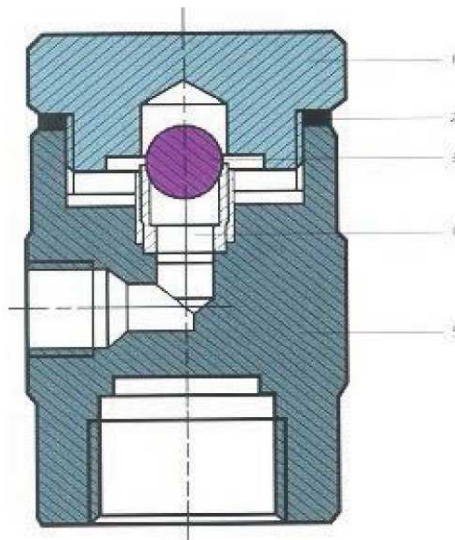

Item	VK70 brass	VK71 stainless steel
1	Cap	Brass
2	Gasket	AISI 304 stainless steel
3	Ball	AISI 304 stainless steel
4	Seat	AISI 304 stainless steel
5	Body	Brass

## FLOW RATE CURVE (dm<sup>3</sup> / s)

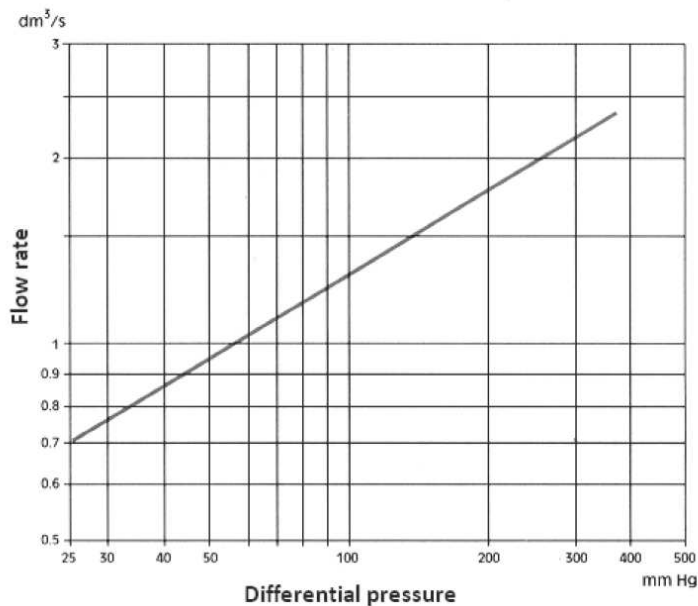

## DIMENSIONS (mm) AND WEIGHT (kg)

DN	A	B	C	Weight (kg)
1/2"	55	34	39	0.35

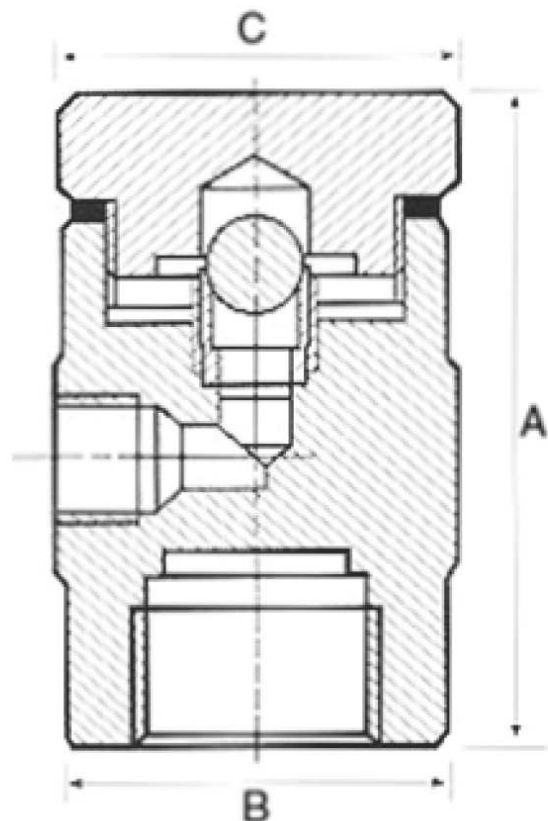

## INSTALLATION

The VK vacuum breaker has to be installed in a vertical position, tapped on the pipework or the device to protect.

## OPTIONS

NPT threaded connections

## MOUNTING AND MAINTENANCE

Before any intervention, please shut off the upstream fluid flow. Depressurize and drain the piping and wait until the installation cooling to room temperature. It is recommended to install a 1/2" tapping pipe on the pipework or the tank to equip. Screw the vacuum breaker on this pipework using an adapted gasket. In case of rough environmental conditions, the air intake can be moved thanks to a hose connected on the 1/8" thread. This device is maintenance-free.