

S38

S38 131.113 class800 DN3/8"- DN2" Gate valve threaded NPT



PED/97/23/CE



Certificate 3.1

- Size :** DN 10 to 50 (NPS 3/8" to 2")
- Ends :** Female - Female BSP or NPT , Socket Welding
- Min Temperature :** - 29°C
- Max Temperature :** + 425°C
- Max Pressure :** 136 Bars (Class 800)
- Specifications :** Rising stem non rotating (OS&Y)
Bolted bonnet and gland pack
Standard port

Materials : Forged carbon steel A105N

SPECIFICATIONS :

- Standard port
- Rising stem non rotating (OS&Y)
- Bolted bonnet and gland pack
- Forged Carbon steel or stainless steel
- ½ stellite (Trim 8)
- Class 800

USE :

- Petroleum industry, steam, high pressure
- Min and max Temperature Ts : - 29°C to + 425°C
- Max Pressure Ps : 136 bars (see graph)

FLOW COEFFICIENT Kvs (M3 / h) :

DN	10	15	20	25	32	40	50
NPS	3/8"	1/2"	3/4"	1"	1"1/4	1"1/2	2"
Kvs (m3/h)	3.7	4.8	10.4	23.4	47.6	69.2	90.8

PRESSURE / TEMPERATURE RELATION :

Pressure (bar)	136,2	136,2	136,2	124,1	120,7	116,6	110	100,7	98,6	97,9	92,7	75,9
Temperature (°C)	-29	0	38	93,5	149	204,5	260	315,5	343,5	371	399	425

PRESSURE / TEMPERATURE GRAPH :

Pressure (Bars)

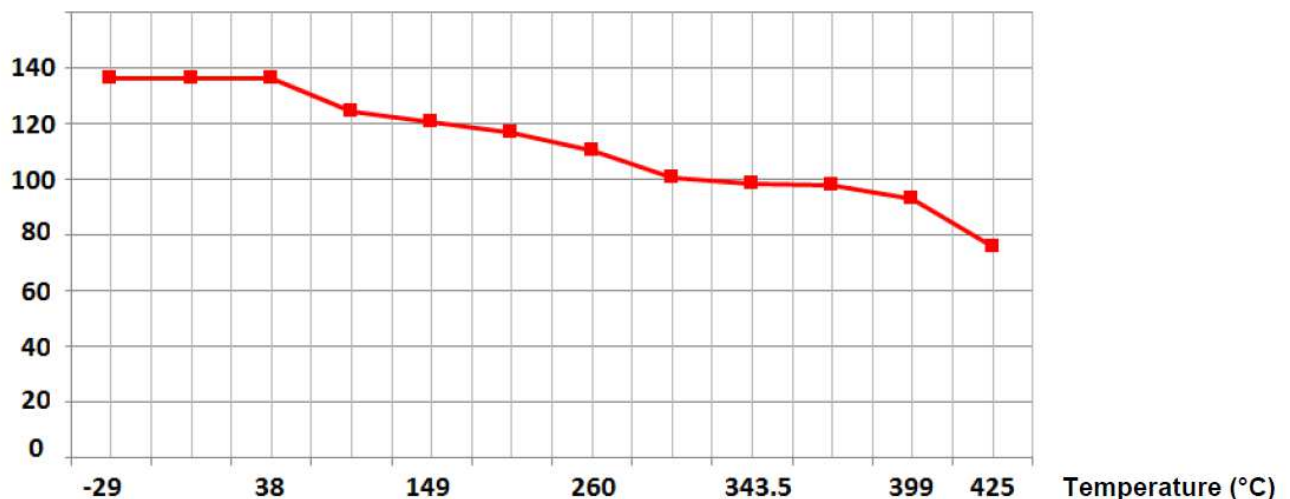

S38

S38 131.113 class800 DN3/8"- DN2" Gate valve threaded NPT

RANGE :

- Forged A105N carbon steel gate valve TRIM 8 with Socket Welding ends **Ref. 112** DN 10 to DN 50 (NPS 3/8" to DN 2")
- Forged A105N carbon steel gate valve TRIM 8 with NPT threaded ends **Ref.113** DN 10 to DN 50 (NPS 3/8" to DN 2")
- Forged A105N carbon steel gate valve TRIM 8 with BSP conical threaded ends **Ref.114** DN 10 to DN 50 (NPS 3/8" to DN 2")

MATERIALS:

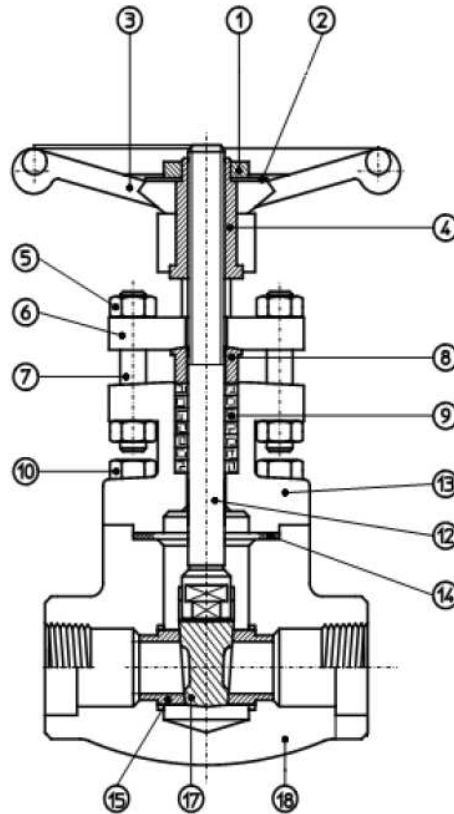

Item	Designation	Materials
1	Wheel nut	Carbon steel
2	Name plate	Aluminium
3	Handwheel	Carbon steel
4	Yoke nut	ASTM A582 type 416
5	Gland nut	ASTM A194 2H
6	Gland flange	ASTM A105
7	Gland stud	SS 410
8	Gland	ASTM A276 type 410
9	Packing	Graphite
10	Bolts	ASTM A193 B7
12	Stem	ASTM A276 type 410
13	Bonnet	ASTM A105N
14	Gasket	SS 316 + graphite spiral wound
15	Seat	ASTM A276 type 410 + Stellite GR.6'
17	Wedge	ASTM A182 F6
18	Body	ASTM A105N

S38

S38 131.113 class800 DN3/8"- DN2" Gate valve threaded NPT

SIZE (in mm) :

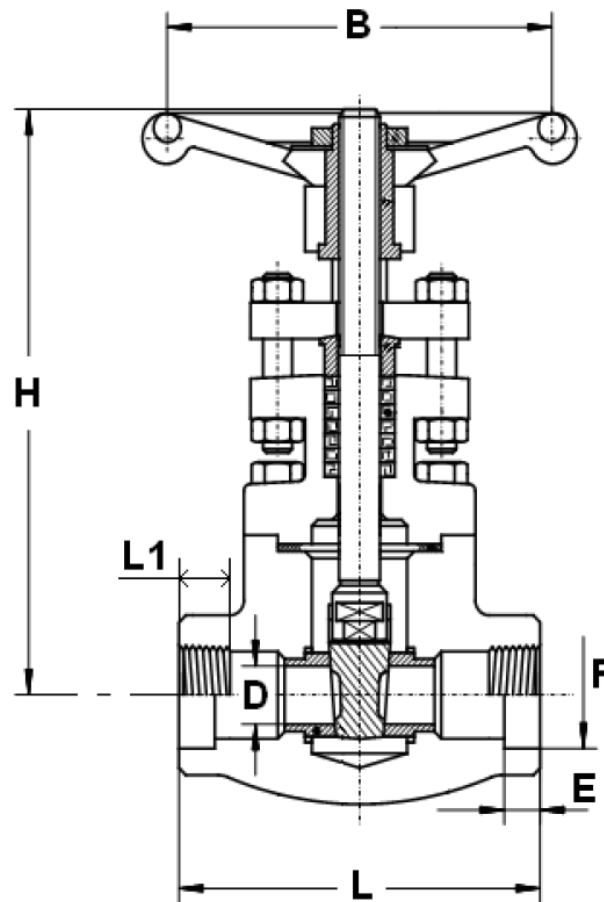

Ref.	DN (mm)	10	15	20	25	32	40	50
	NPS (")	3/8"	1/2"	3/4"	1"	1"1/4	1"1/2	2"
112/113/114 152/153	Ø D	9.6	9.6	14	18	24	30	36.5
	L	80	80	90	110	127	127	127
113/114/153	H (opened)	148	148	163	178	210	243	262
	Ø B	90	90	90	110	110	130	130
112/152	L1	13	15	18	19	20	21	21
	E (SW)	11.1	12.7	14.5	16	17.5	19	22
112/113/114	Ø F (SW)	17.6	21.8	27.2	33.9	42.7	48.8	61.2
	Weight (Kg)	1.84	1.84	2.06	3.35	4.9	6.5	8.8

S38

S38 131.113 class800 DN3/8“- DN2“ Gate valve threaded NPT

STANDARDS :

- Fabrication according to **ISO 9001 : 2008**
- **DIRECTIVE 97/23/CE : CE N° 0036**
Risk category III module H
- Certificate 3.1 on request
- Designing according to **ISO 15761** and **API 602 8th**
- Approval certificate **API 6D**
- Pressure tests according to **API 598, table 6**
- Valves approved by the main oil industries (certificates on request)
- **ATEX Group II Category 2 GD T3 Zone 1 & 21 Zone 2 & 22 (optional marking)** according to directive 2014/34/EU
- Threaded female BSP conical ends according to **ISO 7-1 Rc**
- Threaded female NPT ends according to **ANSI B1.20.1**
- Socket Welding ends according to **ISO 15761**

INSTALLATION INSTRUCTIONS

GENERAL GUIDELINES :

- Ensure that the valves to be used are appropriate for the conditions of the installation (type of fluid, pressure and temperature).
- Be sure to have enough valves to be able to isolate the sections of piping as well as the appropriate equipment for maintenance and repair.
- Ensure that the valves to be installed are of correct strength to be able to support the capacity of their usage.
- Installation of all circuits should ensure that their function can be automatically tested on a regular basis (at least two times a year).

INSTALLATION INSTRUCTIONS :

- **Before installing the valves, clean and remove any objects from the pipes** (in particular bits of sealing and metal) which could obstruct and block the valves.
- **Ensure that both connecting pipes either side of the valve (upstream and downstream) are aligned** (if they're not, the valves may not work correctly).
- **Make sure that the two sections of the pipe (upstream and downstream) match, the valve unit will not absorb any gaps. Any distortions in the pipes may affect the tightness of the connection, the working of the valve and can even cause a rupture. To be sure, place the kit in position to ensure the assembling will work.**
- **During welding operation, for S.W. types half open the valve and do not exceed 350-400°C**
- The theoretical lengths given by ISO/R7 for the tapping are typically longer than required, the length of the thread should be limited, and **check that the end of the tube does not press right up to the head of the thread.**
- **Never use a vice to tighten the fixings of the valve.**
- **If sections of piping do not have their final support in place, they should be temporarily fixed. This is to avoid unnecessary strain on the valve.**
- **It may be necessary to screw the packing gland during using according to the type of use.**
- **Do not use a tool to shut the valve**
- **Fluids in the valve must not contain solid objects (it could damaged the seat).**
- **It's recommended to operate the valve (open and close) 1 to 2 times per year**