

S30

S30 111.158 PN10/16 DN40-300
Gate valve flanged



**Lloyd's
Register**

PED 97/23/CE

Size : DN 40 to DN 300
Ends : Flanges PN10/16 R.F.
Min Temperature : - 10°C
Max Temperature : + 180°C
Max Pressure : 16 Bars
Specifications : Rising stem
Stainless steel stem
SS 304 seat

Materials : Ductile iron body

S30

S30 111.158 PN10/16 DN40-300 Gate valve flanged

SPECIFICATIONS :

- Single wedge disc
- Graphite packing
- Rising stem
- Stainless steel stem
- SS 304 seat
- Flanges R.F. PN10/16
- Body Painting RAL 5005 blue color, 90 µm thickness and red handwheel

USE :

- For common fluids
- Min and max Temperature Ts : - 10°C to + 180°C
- Max Pressure Ps : 16 bars

RANGE :

- Ductile iron body flanged R.F. PN10/16 **Ref. 158** from DN 40 to DN 300

TORQUE VALUES (Nm without safety coefficient) :

DN	40	50	65	80	100	125	150	200	250	300
Torque (Nm)	55	55	55	60	85	115	125	135	192	192

LEAKAGE RATE (WITH WATER AT 20°C) :

DN	Leakage rate (ml/s)
40	0.024
50	0.03
65	0.039
80	0.048
100	0.06
125	0.075
150	0.09
200	0.12
250	0.15
300	0.18

S30

S30 111.158 PN10/16 DN40-300 Gate valve flanged

MATERIALS :

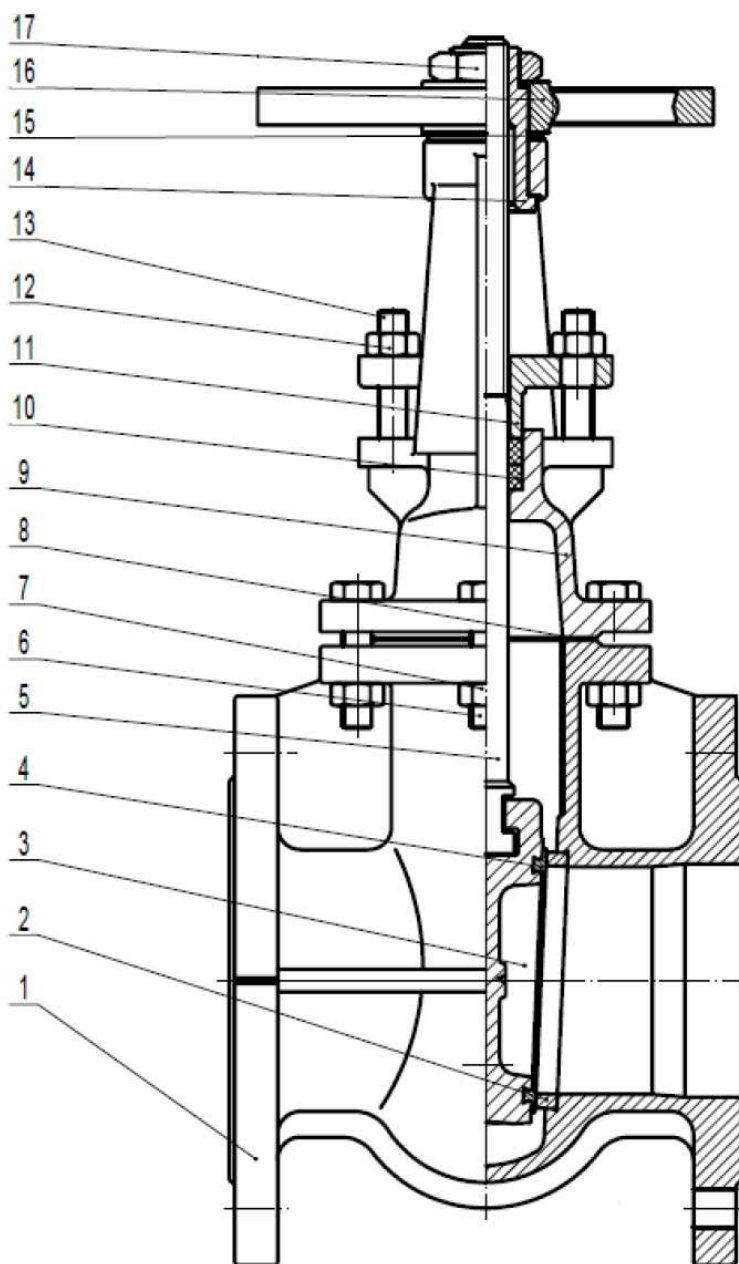

Item	Designation	Materials
1	Body	Ductile iron EN-GJS-500-7
2	Body seat ring	SS 304
3	Wedge	Ductile iron EN-GJS-500-7
4	Wedge seat	SS 304
5	Stem	SS 420
6	Screw	Steel RSt37-2 (1.0038)
7	Nut	Steel RSt37-2 (1.0038)
8	Bonnet gasket	Graphite
9	Bonnet	Ductile iron EN-GJS-500-7
10	Packing	Graphite
11	Packing gland	Ductile iron EN-GJS-500-7
12	Nut	Steel RSt37-2 (1.0038)
13	Screw	Steel RSt37-2 (1.0038)
14	Stem nut	Brass
15	Washer	Brass
16	Handwheel	Cast iron EN GJL-250
17	Handwheel nut	Steel RSt37-2 (1.0038)

S30

S30 111.158 PN10/16 DN40-300 Gate valve flanged

SIZE (in mm) :

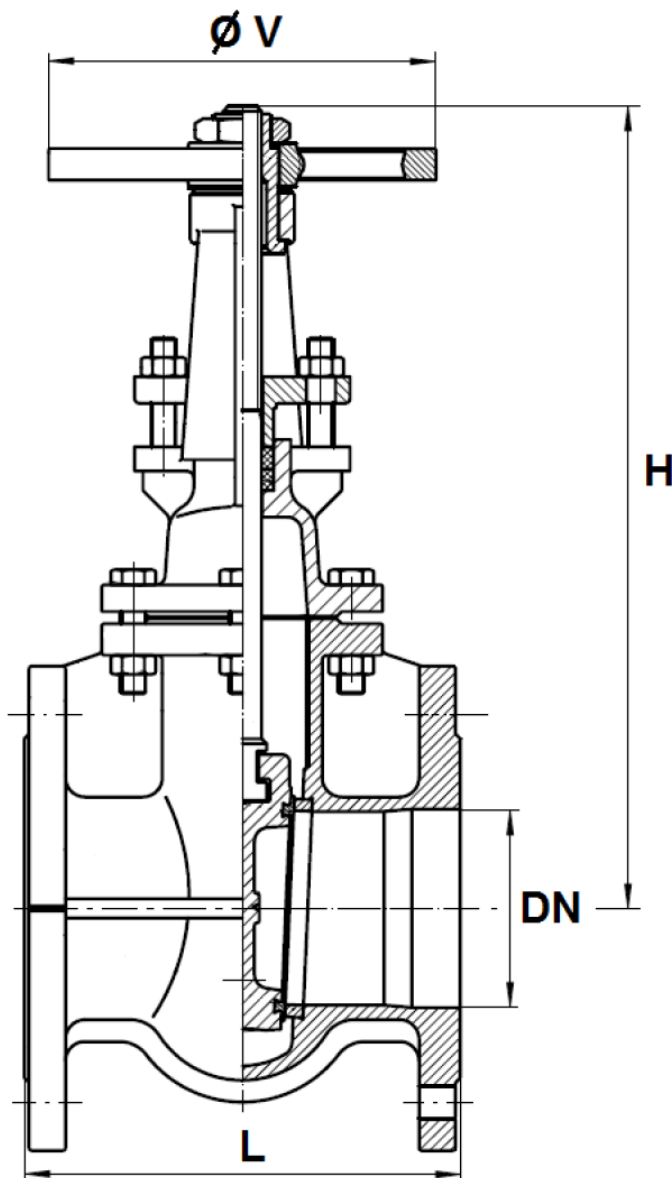

Ref.	DN	40	50	65	80	100	125	150	200	250	300
158	L	136	142	154	160	172	186	200	228	255	285
	H (closed)	244	254	294	331	385	457	545	683	823	952
	H (opened)	295	315	371	424	500	598	711	901	1092	1273
	Ø V	160	160	160	160	200	200	250	250	320	320
	Weight (Kg)	9.5	10.7	13.3	17.2	22.1	31.3	46.5	69.1	105.4	172.2

S30

S30 111.158 PN10/16 DN40-300 Gate valve flanged

FLANGES SIZE PN16 (in mm) :

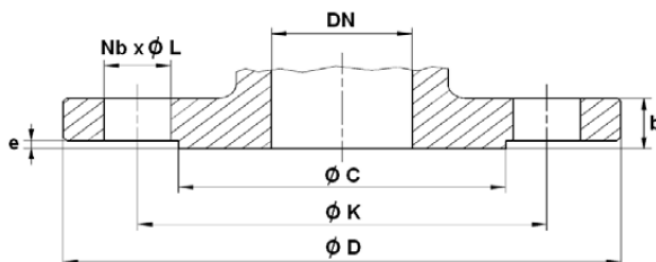

DN	40	50	65	80	100	125	150	200	250	300
Ø C	80	102	124	140	158	188	212	268	319	370
Ø D	150	165	185	200	220	250	285	340	405	460
Ø K	110	125	145	160	180	210	240	295	355	410
Nb x Ø L	4 x 19	4 x 19	4 x 19	8 x 19	8 x 19	8 x 19	8 x 23	12 x 23	12 x 28	12 x 28
b	16	16	16	17	17	18	20	21	22	24.5
e	2	2	2	2	2	3	3	3	3	3
Ref.	158040	158050	158065	158080	158100	158125	158150	158200	158250	158300

FLANGES SIZE PN10 (in mm) :

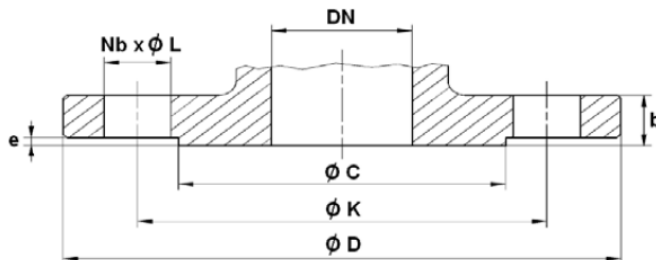

DN	200	250	300
Ø C	268	320	370
Ø D	340	395	445
Ø K	295	350	400
Nb x Ø L	8 x 23	12 x 23	12 x 23
b	21	23	24
e	3	3	4
Ref.	158201	158251	158301

S30

S30 111.158 PN10/16 DN40-300
Gate valve flanged

STANDARDS :

- Fabrication according to ISO 9001 : 2008
- DIRECTIVE 97/23/CE : CE N° 0038
Risk Category III module H
- Pressure tests according to EN 12266-1, range B
- Length according to EN 558 series 29 (NF 29323)
- Flanged R.F. according to EN 1092-2 PN10/16
- Design according to DIN 3352

INSTALLATION INSTRUCTIONS

GENERAL GUIDELINES :

- Ensure that the valves to be used are appropriate for the conditions of the installation (type of fluid, pressure and temperature).
- Be sure to have enough valves to be able to isolate the sections of piping as well as the appropriate equipment for maintenance and repair.
- Ensure that the valves to be installed are of correct strength to be able to support the capacity of their usage.
- **Installation of all circuits should ensure that their function can be automatically tested on a regular basis (at least two times a year).**

INSTALLATION INSTRUCTIONS :

- **Before installing the valves, clean and remove any objects from the pipes** (in particular bits of sealing and metal) which could obstruct and block the valves.
- **Ensure that both connecting pipes either side of the valve (upstream and downstream) are aligned (if they're not, the valves may not work correctly).**
- **Make sure that the two sections of the pipe (upstream and downstream) match, the valve unit will not absorb any gaps. Any distortions in the pipes may affect the tightness of the connection, the working of the valve and can even cause a rupture. To be sure, place the kit in position to ensure the assembling will work.**
- **If sections of piping do not have their final support in place, they should be temporarily fixed. This is to avoid unnecessary strain on the valve.**
- Tighten the bolts in cross.
- It's recommended to operate the valve (open and close) 1 to 2 times per year