

L10

L10 117 5100.265 F2 DN50-DN600 Check valve swing flange DIN

standard features

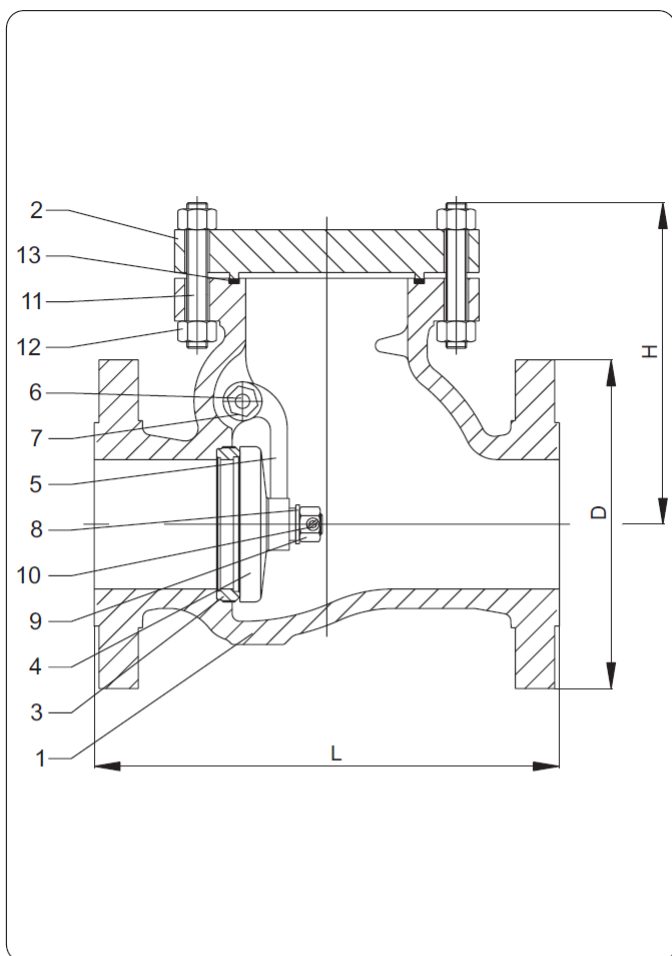

- **Description** FULL OPENING
BOLTED COVER
LAPPED DISC AND SEAT
RENEWABLE SEAT
- **Design** DIN 3840
- **Face to face** DIN 3202
- **Flanges** DIN 2501
DIN 2547
DIN 2526 FORM E
BW TO DIN 3239
- **Testing** DIN 3352 Part 1
DIN 3230 Part 3
- **Rating** DIN 2401
- **Marking** EN 19
CE - PED

| PART NAME | | MATERIAL | | | |
|-----------|-------------------|---|---------------------|-------------------|------------------------|
| 1 | Body | 1.0619 | 1.7363 | 1.4552 | 1.4581 |
| 2 | Cover | 1.0619 | 1.7363 | 1.4552 | 1.4581 |
| 3 | Seat ring surface | X20Cr13 (1) | X20Cr13 (1) | X6CrNiTi18-10 (1) | X5CrNiMo17-12-2 (1) |
| 4 | Disc seat surface | X20Cr13 (2) | X20Cr13 (2) | X6CrNiTi18-10 (2) | X5CrNiMo17-12-2 (2) |
| 5 | Hinge | 1.0619 (3) | X5CrNiMo17-12-2 (3) | X6CrNiTi18-10 (3) | GX5CrNiMoNb19-11-2 (3) |
| 6 | Inge pin | X20Cr13 | X20Cr13 | X6CrNiTi18-10 | X5CrNiMo17-12-2 |
| 7 | Plug | 1.0460 | X5CrNiMo17-12-2 | X5CrNiMo17-12-2 | X5CrNiMo17-12-2 |
| 8 | Plate | 1.0460 | X5CrNiMo17-12-2 | X5CrNiMo17-12-2 | X5CrNiMo17-12-2 |
| 9 | Nut | C35 | 24CrMo5 | A2-70 | A2-70 |
| 10 | Pin | X5CrNiMo17-12-2 | X5CrNiMo17-12-2 | X5CrNiMo17-12-2 | X5CrNiMo17-12-2 |
| 11 | Bolts | CK35 | 21CrMoV57 | A2-70 | A2-70 |
| 12 | Nut | C35 | 24CrMo5 | A2-70 | A2-70 |
| 13 | Gasket | ← S.S. spiral wound reinforced graphite (4) → | | | |

L10 117 5100.265 SWING CHECK VALVES DIN PN100 Face to Face F2

| SIZE DN | 50 | 65 | 80 | 100 | 125 | 150 | 200 | 250 | 300 | 350 | 400 | 500 | 600 | 700 | 800 | 900 | 1000 |
|---------|-----|-----|-----|-----|-----|-----|-----|-----|-----|------|------|------|------|-----|-----|-----|------|
| L RF/BW | 300 | 340 | 380 | 430 | 500 | 550 | 650 | 775 | 900 | 1025 | 1150 | 1400 | 1600 | -- | -- | -- | -- |
| D | 195 | 220 | 230 | 265 | 315 | 355 | 430 | 505 | 585 | 655 | 715 | 870 | 990 | -- | -- | -- | -- |
| H | 195 | 210 | 230 | 290 | 305 | 370 | 410 | 470 | 520 | -- | -- | -- | -- | -- | -- | -- | -- |

L10

L10 117 5100.265 F2 DN50-DN600
Check valve swing flange DIN
